



650 Madison St.
PO Box 64486
Gary, IN 46401-0486
www.indiana-american.com

January 21, 2011

Subject: Meter Pit Requirement

Dear Customers:

As of November 1st 2010, INAW Corporate Engineering changed their requirements regarding new service installs. All new services must include a meter pit. Service lines and pit installation costs are the responsibility of the customer.

Meter pits shall be installed on the customer property at the property line. Piping in and out of all pits must be type "K" copper. Larger services may use D.I. No exceptions! Customer service lines after the pit may be a material of customer's choice providing it complies with local building code.

Attached please find examples of typical meter pit installations. These drawings are for informational purposes only and should be used as a guideline. All meters up to and including 1-inch will use the meter yokes. All meter pits intended to house 1.5-inch and larger meters must be drawn as intended to be installed, and submitted for approval prior to service installation scheduled by INAW.

Please feel free to contact us with any questions.

Royce Thompson – Engineering Estimator (219) 880-2349

Marie Oliver – Engineering Clerk (219) 880-2352

Sincerely,

INAW New Business Staff
Elizabeth Loudermilk, Dave Clark, Mark
Matlock, Jeff King, Royce Thompson, and
Marie Oliver

**-PRELIMINARY-
NOT FOR CONSTRUCTION**

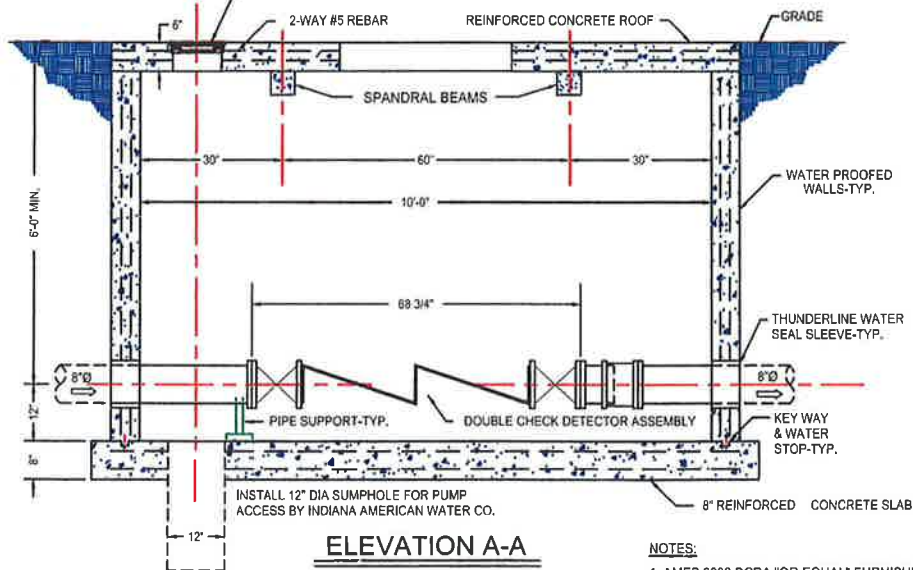
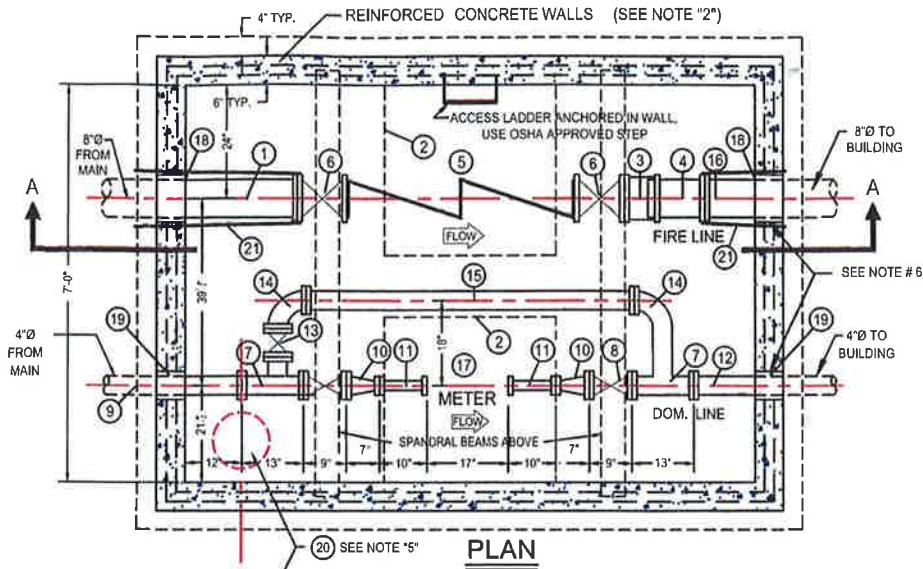

NO.	SIZE	BILL OF MATERIALS	AMT.
1	8"	FLG/PE, C.I. NIPPLE ASA A21.6, AWWA C 106-12-CL#125	1
2	36"x36"	BILCO TYPE J-4AL HATCH W/FLUSH LIFT HANDLE & LOCK DEVICE	2
3	8"	FLG/C.I. DRESSER ADAPTER, CL #125, STYLE 128	1
4	8"	FLG/FLG, NIPPLE ASA A21.6, AWWA C106-62-CL #125	1
5	8"	AMES 3000 DCDA DOUBLE CHECK DETECTOR ASSEMBLY "OR EQUAL"	1
6	8"	FLG/FLG OS&Y GATE VALVE/HW, AWWA, UL & FM ACR	2
7	4"x2"	FLG/FLG C.I. TEE, ANSI A21.10, AWWA C110-CL#125	2
8	4"	FLG/FLG NRS GATE VALVE/HW, AWWA-CL#125	2
9	4"	FLG/PE C.I. NIPPLE ASA A21.6, AWWA C106-62-CL#125	1
10	4"x2"	7" LONG REDUCER	2
11	2"	FLG/FLG, NIPPLE ASA A21.6, AWWA C106-62-CL #125	2
12	4"	FLG/PE C.I. NIPPLE ASA A21.6, AWWA C106-12-CL#125	1
13	2"	FLG/FLG NRS GATE VALVE/HW, AWWA-CL#125	2
14	2"	FLG/FLG C.I. 90° ELBOW, ANSI A21.10, AWWA C110-CL#125	2
15	2"	FLG/FLG C.I. NIPPLE ASA A21.6, AWWA C106-62-CL#125	1
16	8"	FLG/PE C.I. NIPPLE ASA A21.6, AWWA C106-12-CL#125	1
17	2"	TRIDENT METER FURNISHED BY UTILITY (17" FLG TO FLG.)	1
18	8"	THUNDERLINE CS-8-LS400-C-7 WALL SLEEVE OR EQUAL WATER TIGHT SEAL	2
19	4"	THUNDERLINE CS-4-LS400-C-5 WALL SLEEVE OR EQUAL WATER TIGHT SEAL	2
20	-	EAST JORDAN IRON WORKS #1577 MANHOLE COVER	1
21	-	(4) THREADED ROD(S) WELDED W/ GRIPPER RING(S) FOR TIE-BACKS	2 SETS
22	-	(2) THREADED ROD(S) WELDED W/ GRIPPER RINGS OR FIELD LOCK GASKETS	2 SETS

NOTES:

- AMES 3000 DCDA "OR EQUAL" FURNISHED BY OTHERS. I.N.A.W.C. WILL INSTALL SIDE METER IN BY-PASS ASSEMBLY THAT INCLUDES SHUT-OFF VALVE AND DOUBLE CHECK BACKFLOW PREVENTER. ALL OTHER MATERIALS, PIPING AND VAULT CONNECTION IS BY THE CUSTOMER. A FINAL INSPECTION IS REQUIRED BEFORE THE UTILITY WILL GIVE SERVICE.
- TIE WALLS TO ROOF WITH #4 CANTILEVER REINFORCEMENT. TIE BACK FITTINGS TO VAULT WALLS WITH TIE-BACK BOLTS.
- PIPING AND FITTINGS TO CONFORM TO AWWA ANSI STANDARD C600-87 & C151/A21.51 DUCTILE IRON CLASS 51 OR 52 PIPE WITH OUTSIDE COATING AND CEMENT-MORTAR LINING. SUPPORT PIPING AS NEEDED.
- CENTER ACCESS HATCHES OVER DOUBLE CHECK AND WATER METER.
- CENTER ACCESS COVER OVER SUMP HOLE.
- REBAR TO BE SIZED PER ENGINEERING DESIGN.



EXAMPLE

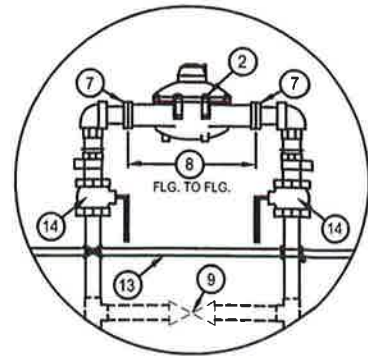
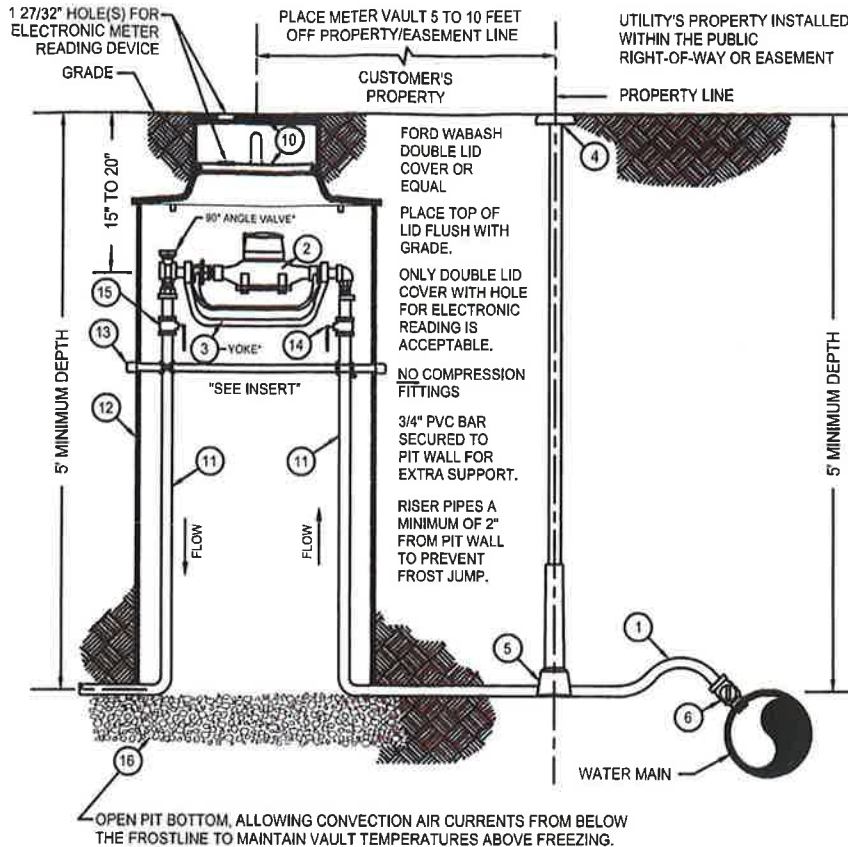

INSERT FOR 1 1/2" - 2" METERS
NO METER YOKE USED

NOTE:
THIS SKETCH AND MATERIAL LIST IS INTENDED FOR A PRELIMINARY PROPOSAL OF A METER VAULT AND IS NOT TO BE USED AS A CONSTRUCTION DRAWING. A FINAL PLAN, IN DETAIL, IS REQUIRED TO BE SUBMITTED BY THE CUSTOMER TO OUR ENGINEERING DEPARTMENT FOR APPROVAL. COMPRESSION FITTINGS ARE UNACCEPTABLE! ALL MATERIALS AND CONSTRUCTION ARE TO BE PROVIDED BY THE CUSTOMER EXCEPT AS NOTED. A FINAL INSPECTION WILL BE REQUIRED BEFORE THE METER CAN BE SET. IF YOU HAVE ANY QUESTIONS, CONTACT OUR ENGINEERING DEPARTMENT AT (219) 880-2385.

	ITEM NO.	DESCRIPTION	SIZES									
FURNISHED AND/OR INSTALLED BY UTILITY	1.	TYPE "K" COPPER-I.D.	3/4"	3/4"	1"	1"	1 1/2"	1 1/2"	2"	2"		
	2.	WATER METER	5/8"	3/4"	3/4"	1"	1"	1 1/2"	1 1/2"	2"		
	3.	METER YOKE ⁽¹⁾	5/8"	3/4"	3/4"	1"	1"					
	4.	SERVICE (BUFFALO) BOX	1"	1"	1"	1"	1"	1"	1"	1"		
	5.	CURB STOP	3/4"	3/4"	1"	1"	1 1/2"	1 1/2"	2"	2"		
	6.	CORPORATION STOP	3/4"	3/4"	1"	1"	1 1/2"	1 1/2"	2"	2"		
	7.	METER FLANGES - 2 REQ'D ⁽²⁾							1 1/2"	1 1/2"	2"	
	8.	SPACE BETWEEN FLANGES							13 1/4"	13 1/4"	17 1/4"	
FURNISHED AND INSTALLED BY CUSTOMER	9.	BY-PASS W/LOCKOUT VALVE							1"	1"	1 1/2"	
	10.	DOUBLE LID COVER ⁽³⁾	18"	18"	18"	18"	24"	36"	36"	36"		
	11.	TYPE "K" COPPER-I.D.	3/4"	3/4"	1"	1"	1 1/2"	1 1/2"	2"	2"		
	12.	RIDGID PVC OR CONCRETE-I.D.	24"	24"	24"	24"	24"	36"	36"	36"		
	13.	PVC BAR	3/4"	3/4"	3/4"	3/4"	3/4"	3/4"	3/4"	3/4"		
	14.	BALL VALVE	3/4"	3/4"	1"	1"	1 1/2"	1 1/2"	2"	2"		
	15.	BALL VALVE	3/4"	3/4"	1"	1"	1 1/2"	1 1/2"	2"	2"		
	16.	DEPTH OF GRAVEL (NO SLAG)	6"	6"	6"	6"	6"	6"	6"	6"		

FOOTNOTES: (1) METER YOKE ASSEMBLY, COMPLETE WITH 90° ELBOW & ANGLE VALVE FURNISHED BY UTILITY, INSTALLED BY CUSTOMER FOR 5/8" THRU 1" METERS.

(2) METER FLANGES FURNISHED BY UTILITY, INSTALLED BY CUSTOMER FOR 1 1/2" & 2" METERS.

(3) FORD WABASH DOUBLE LID COVER WITH HOLE FOR ELECTRONIC READING, OR EQUAL.



INDIANA

AMERICAN WATER

650 Madison Street, P.O. Box 64486 Gary, Indiana 46401-0486
(219) 880-2349 FAX: (219) 881-2313

TITLE: METER VAULT ASSEMBLY - (CURB VAULTS)

TASK NUMBER(S)

DRAWN BY: A. BEST & ROYCE T.

ATLAS:

CHK'D BY: R. FENA & E. PATZ

FIELD BOOK:

DATE: 07/28/98

SCALE: AS NOTED

CADD SHEET FILE NUMBER: DOMVAL2.DWG



REVISED

12/03/02

10/16/03

12/10/04

05/01/06

05/18/10

10/26/10

DRAWING NO.

SHEET OF

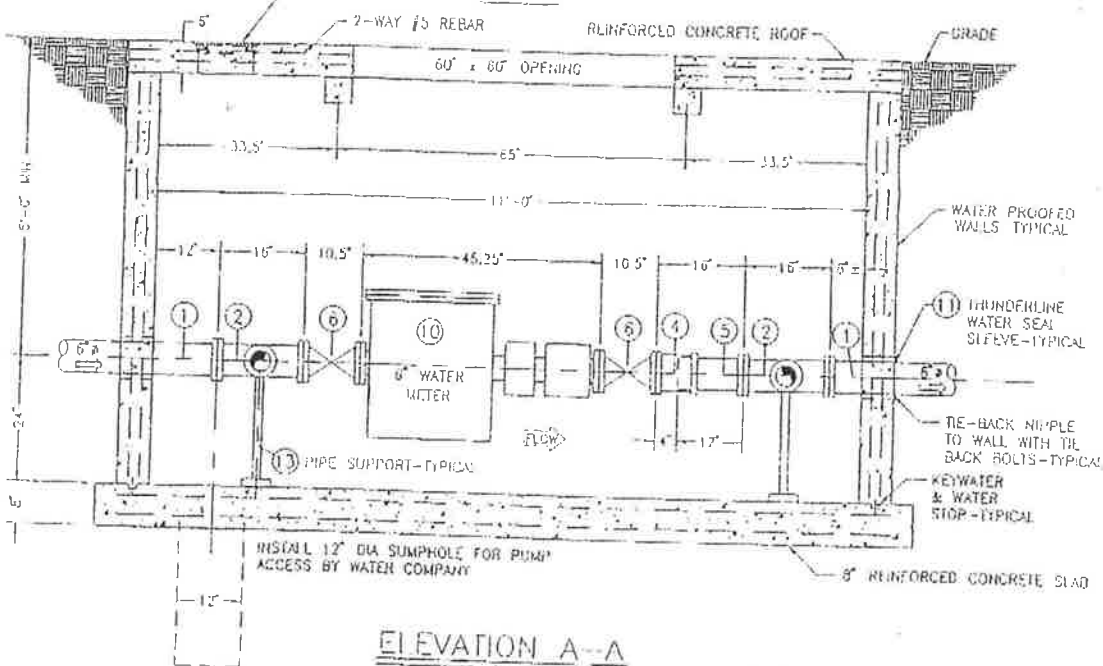
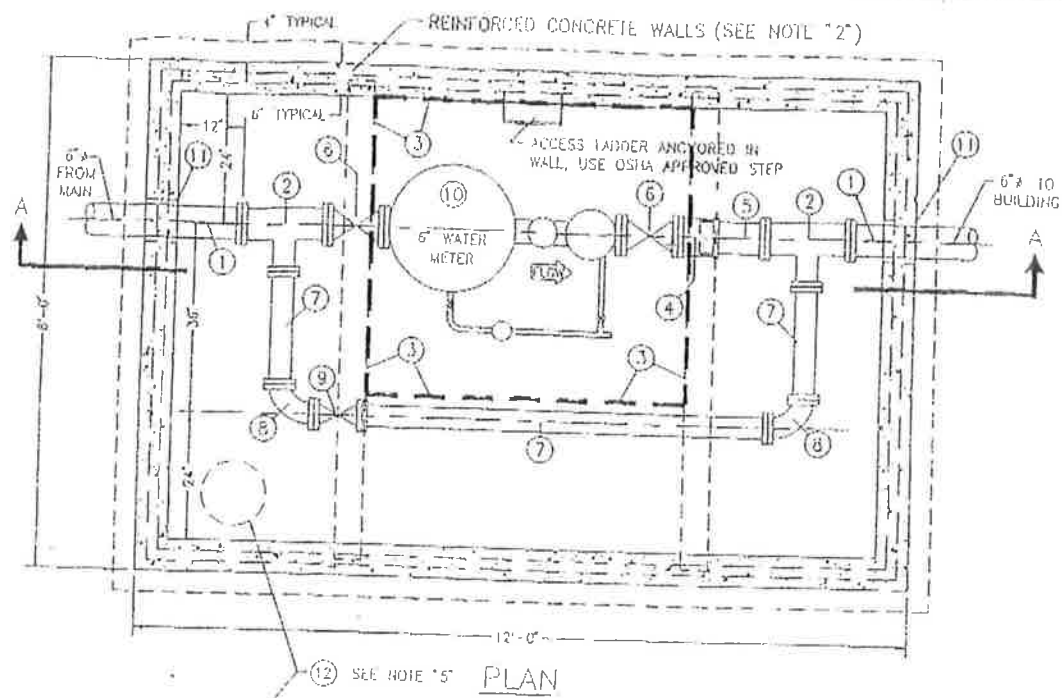

NO	SIZE	BILL OF MATERIALS	AMT
1	5"	FLG/P.L. C.I. NIPPLE ASA A21.6, AWWA C 106-12-CL#125	2
2	6" x 4"	FLG/FLG C.I. TEE, ANSI A21.10, AWWA C110, -CL#125	2
3	60" x 60"	BILCO TYPE PDCM-4 DOUBLE LEAF W/FLUSH LIFT HANDLE & LOCK	1
4	6"	FLG/C.I. DRESSER ADAPTER, CL #125, STYLE 128	1
5	6" x 12"	FLG/P.L. NIPPLE ASA A21.6, AWWA C106-62-CL #125	1
6	6"	FLG/FLG OS&Y GATE VALVE/HW, AWWA, UL & FM ACR	1
7	4"	FLG/FLG C.I. NIPPLE ASA A21.6, AWWA C106-62-CL#125	2
8	4"	FLG/FLG C.I. 90 ELBOW, ANSI A21.10, AWWA C110-CL#125	3
9	4"	FLG/FLG NON-RISING STEM GATE VALVE/HANDWHEEL, AWWA-CL#125	2
10	5"	PROTECTUS II WATER METER	1
11	6"	THUNDERLINE CS-5-8-LS400-C-7 WALL SLEEVE	1
12	-	EAST JORDAN IRON WORKS #1577 MANHOLE COVER	2
13	-	PIPE SUPPORTS AS NEEDED	1

NOTES:

1. WATER METER IS PROVIDED AND INSTALLED BY WATER COMPANY. ALL OTHER MATERIAL, PIPING AND VAULT CONNECTION IS BY THE CUSTOMER. A FINAL INSPECTION IS REQUIRED BEFORE THE UTILITY WILL GIVE SERVICE.
2. TIE WALLS TO ROOF WITH #4 CANTILEVER REINFORCEMENT. TIE BACK FITTINGS TO VAULT WALLS WITH TIE-BACK BOLTS.
3. PIPING AND FITTINGS TO CONFORM TO AWWA ANSI STANDARD C600-87 & C151/A21.51 DUCTILE IRON CLASS 51 OR 52 PIPE WITH OUTSIDE COATING AND CEMENT-MORTAR LINING. SUPPORT PIPING AS NEEDED.
4. CENTER ACCESS HATCH OVER WATER METER
5. CENTER ACCESS COVER OVER SUMP HOLE

Indiana-American
Water Company, Inc.
 550 Madison Street, P.O. Box 1400, Gary, Indiana 46401-0400
 (219) 840-2129 FAX: (219) 861-2209

TITLE: METER VAULT FOR LARGE SERVICE CONNECTION

TASK NUMBER	DRAWN BY: CUSH	ATLAS:
	CHK'D BY: W. RIGBY	FIELD BOOK:
	DATE: 08/26/96	SCALE: 1/2" = 1'-0"
	CADD SHEET FILE NUMBER: TYPXVLCG.DWG	



REVISED
05/19/00

DRAWING NO.

SHEET
OF